

since 1986
Burke Acoustics
Sound in Progress

Wall and Ceiling Panel
Fixing Systems

Wall Fixings



Glucksman Library, University of Limerick – Limerick, Ireland



One South County – Dublin, Ireland

Clip Fixing

Easy and practical
installing at vertical
and horizontal panels.

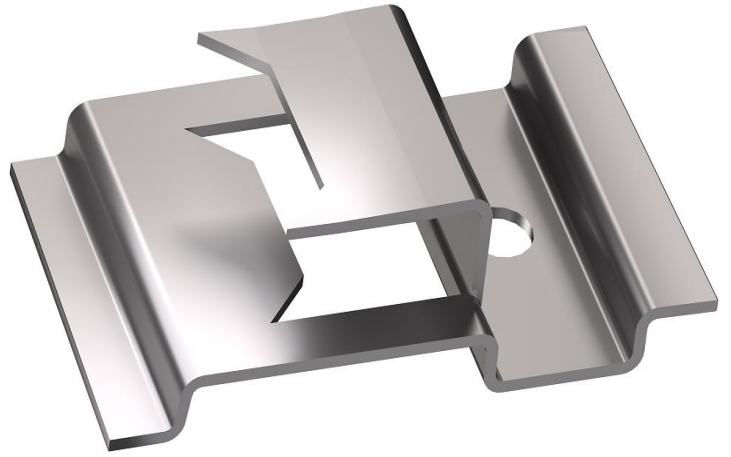

Rail System

Wall fixing panel system using galvanized steel profiles, allowing flushed and grooved meeting edges.



WL 21/48

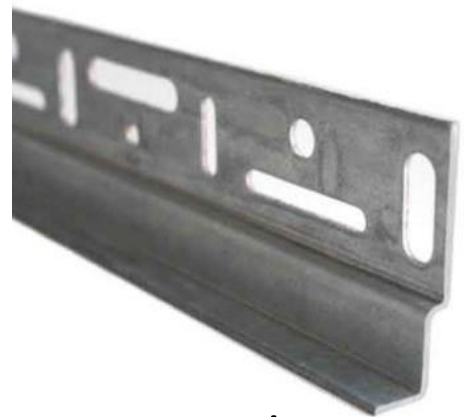

PL 16/48



PL 32/48

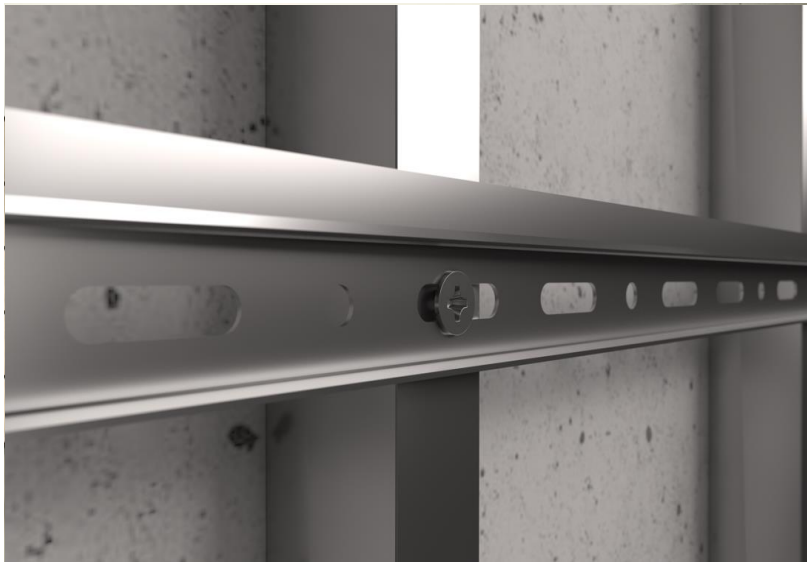

Rail System

Wall fixing panel system using galvanized steel profiles, allowing flushed and grooved meeting edges.



Wall/Panel Rails

Wall surface mounted, the panels are fixed directly on the structure wall.

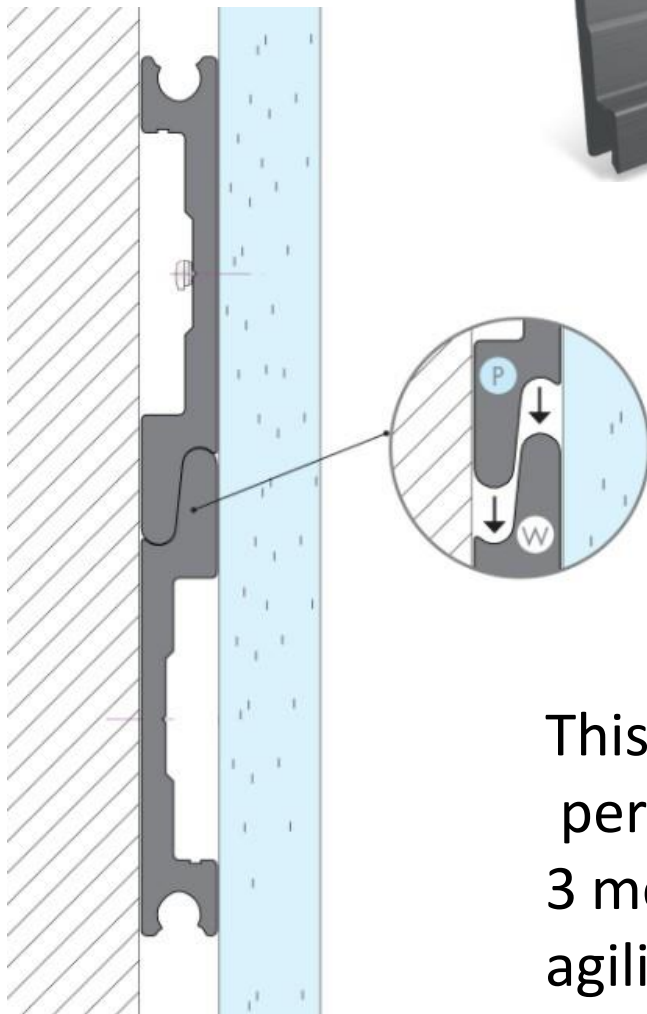

Simple and easy wall fixing and rail fitting.

This installation type permit a maximum of 3 meters length, providing agility and economy.

Hook-in Profile

A single aluminium profile rail fixed through the wall and panel, working as a hooking system.

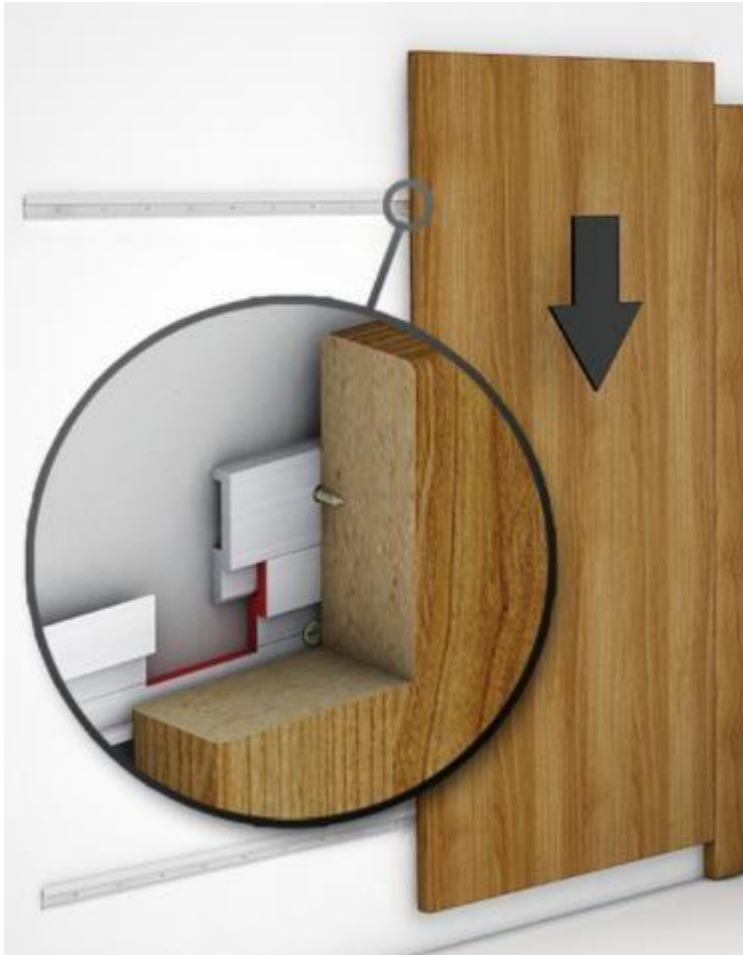

This system can be applied for vertical and horizontal panels

Timber Split-batten

Two timber pieces are positioned upside-down in opposite directions to form a simple fitting system, using only the panel weight.

One component is screwed on the wall and the other piece is screwed on the panel.

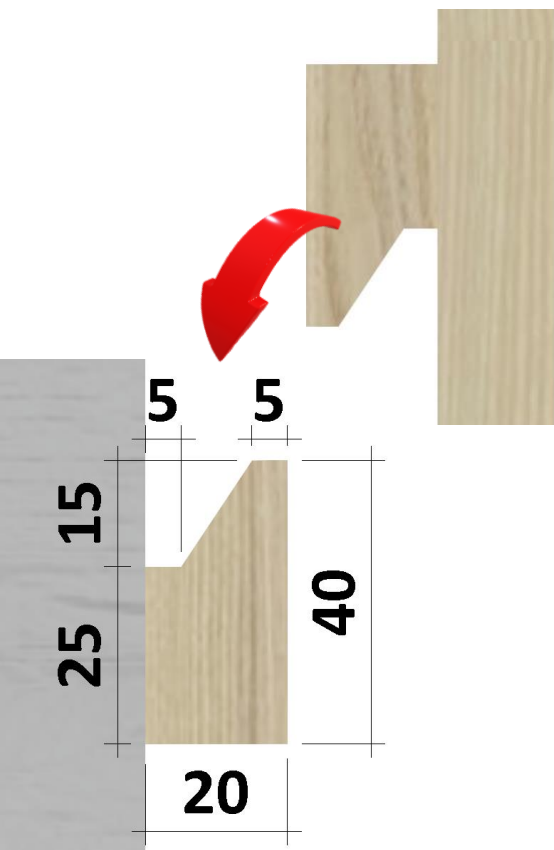

The Timber Split-batten components dimensions may vary depending on the weight of the panel.

Ceiling Fixings

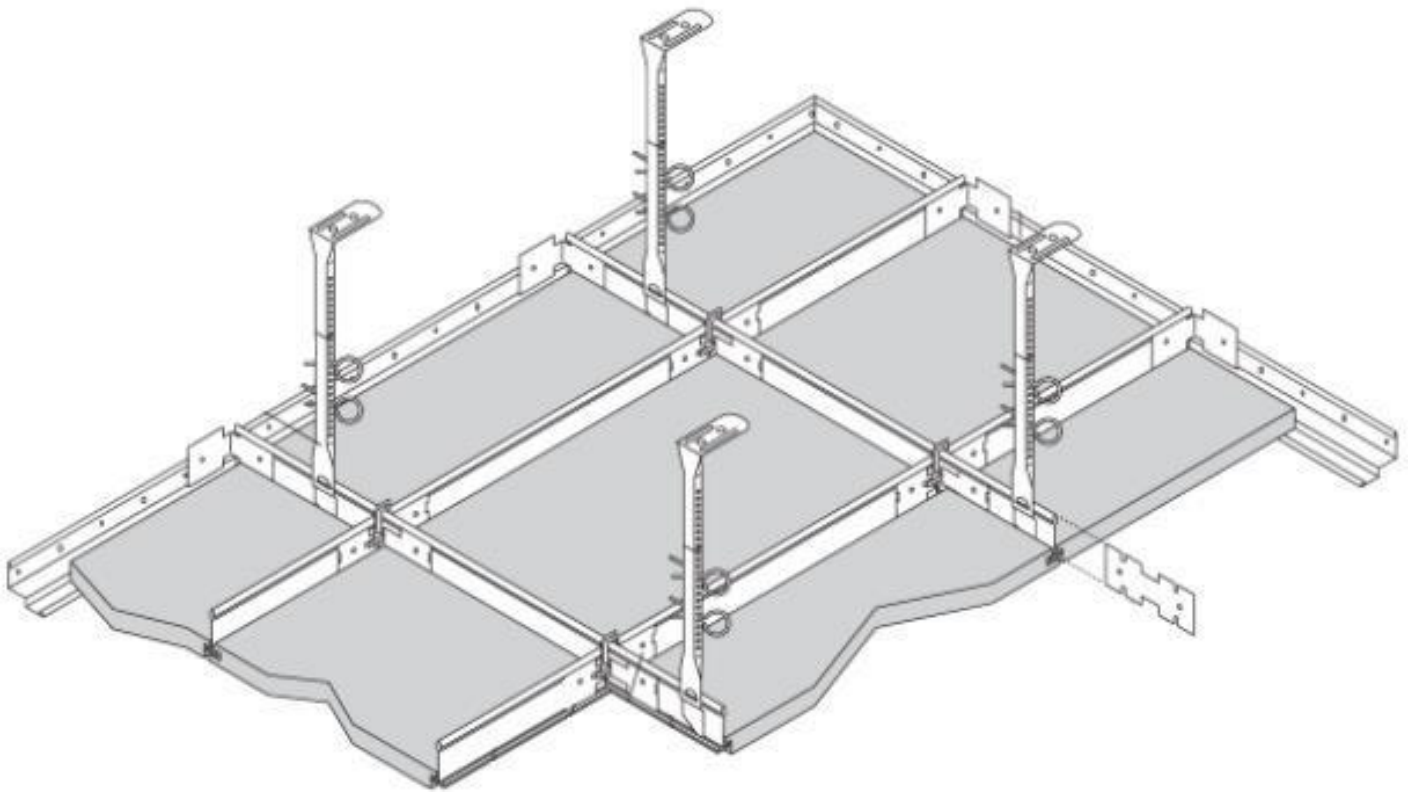

Exposed T-Grid

T- Grid system uses galvanized steel profiles performing an exposed junction between the panels.

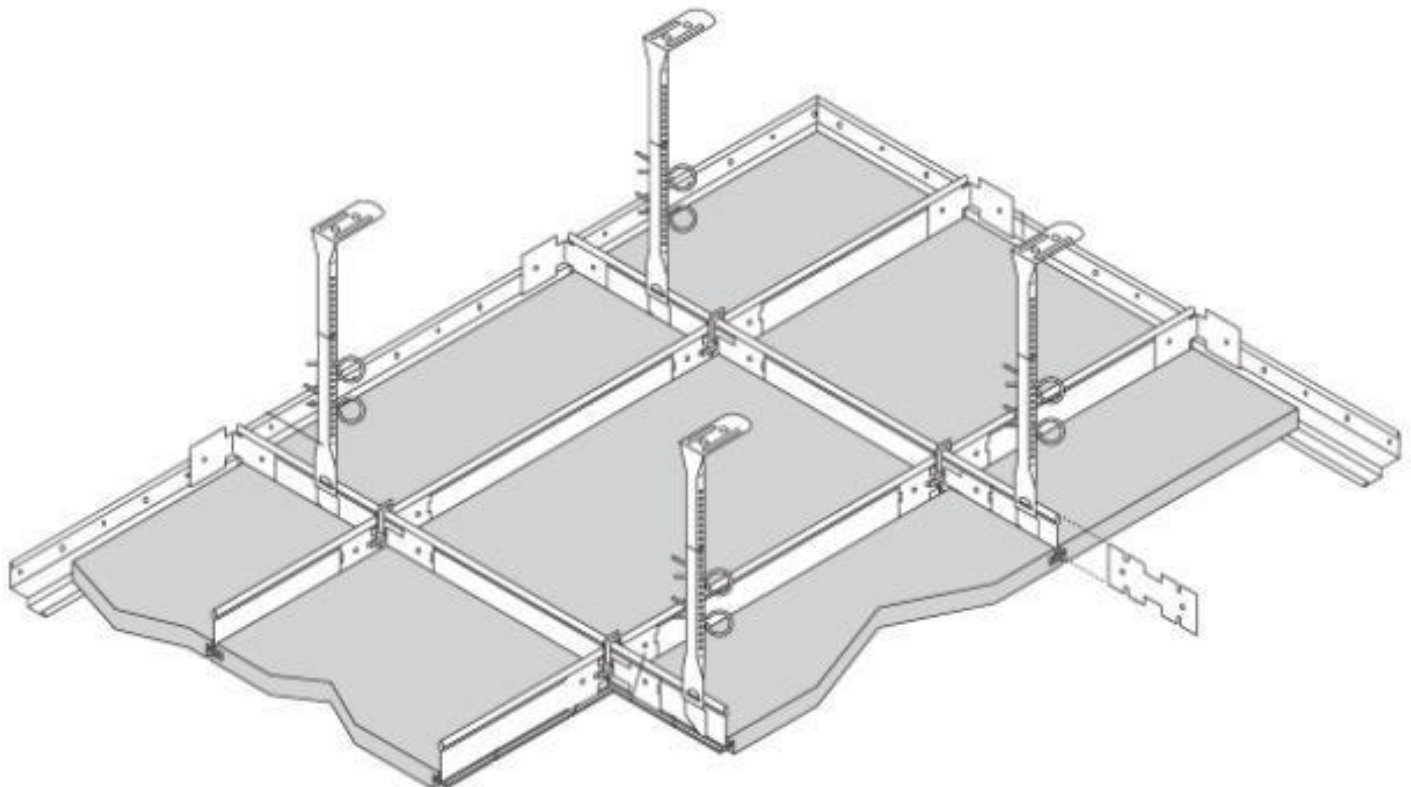
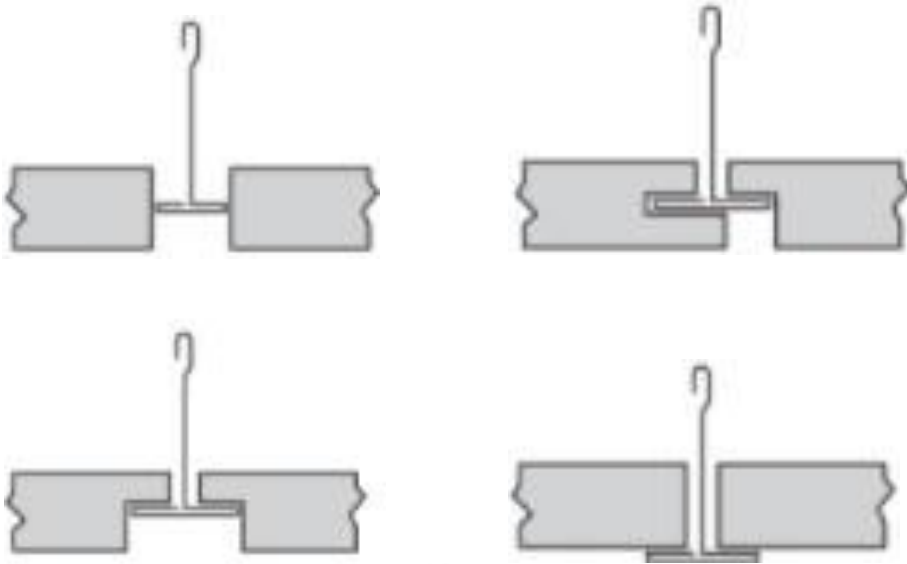

Concealed Demountable

Galvanized steel profiles fixed to substructure allows an easy and practical panel installation.

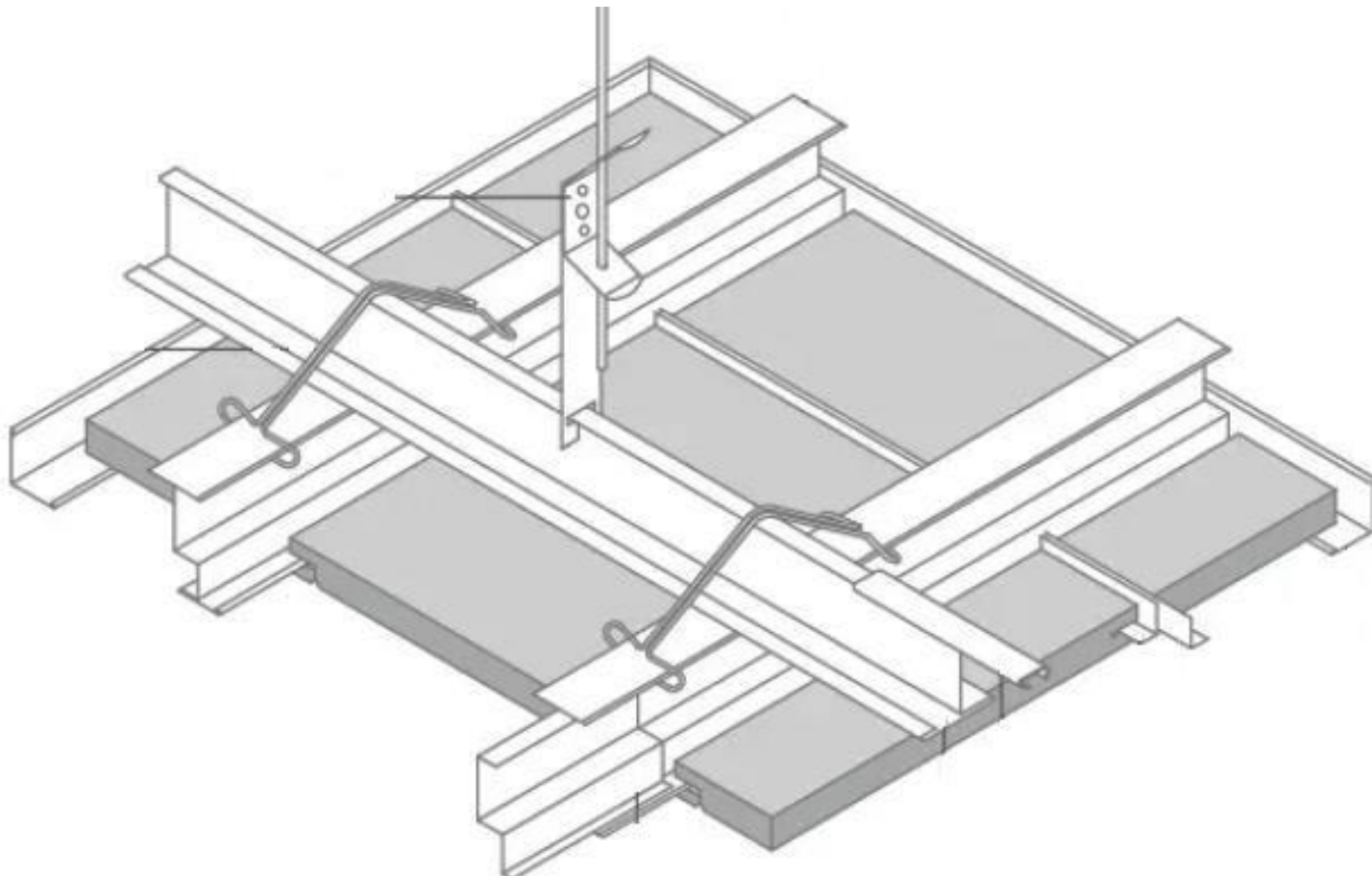
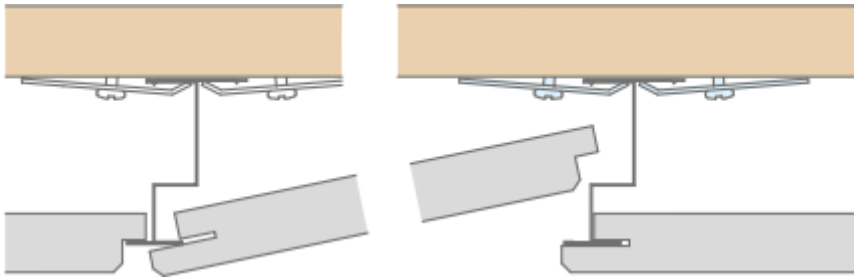

Suspended Rails

Galvanized steel profiles recommended for large areas as sports pavilions, large reception halls or convention centres.

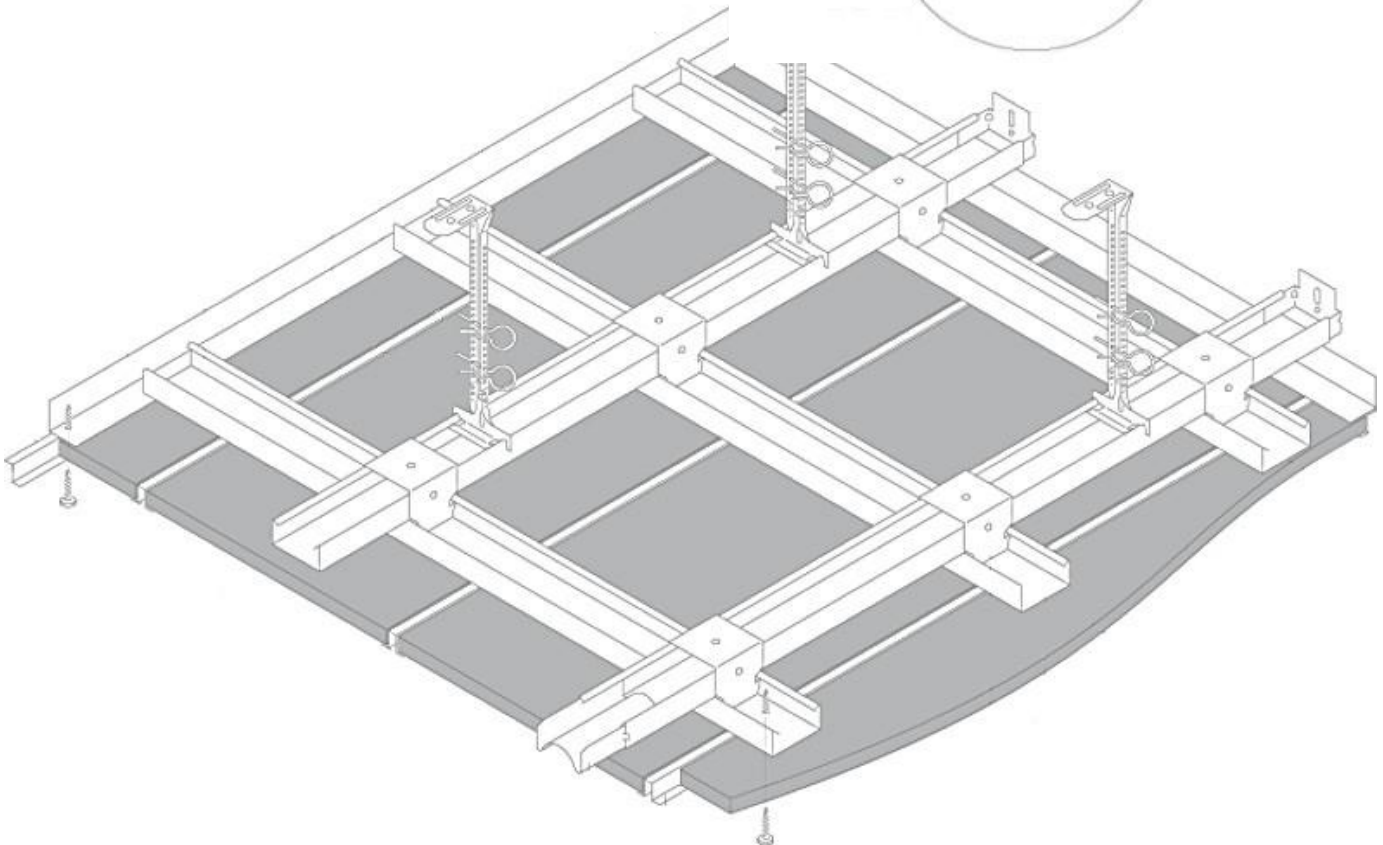
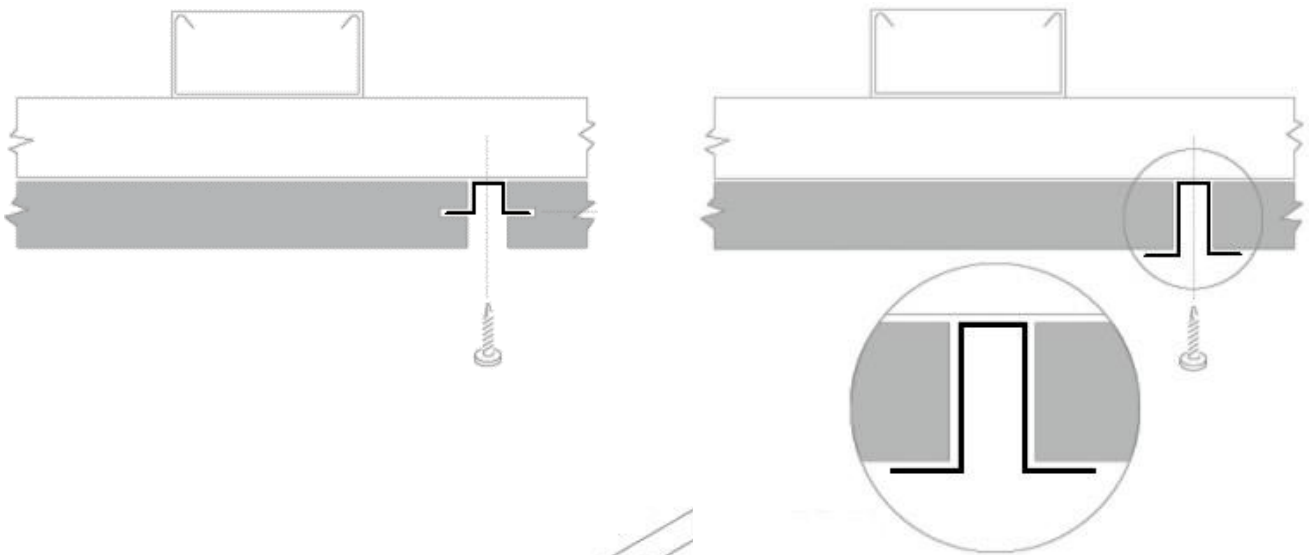

Contact us

 Ireland: +353 (0) 1 6268129
Germany: +49 176 56 844 008

 www.burkeacoustics.com

 info@burkeacoustics.com

 Unit 1F, Kylemore Park South,
Ballyfermot, Dublin 10.

 *Burke Acoustics*

